

# CATENE A MAGLIA PARI DISASSATE SERIE MT

## CHAIN STRAIGHT OFF SET PLATES TYPE MT

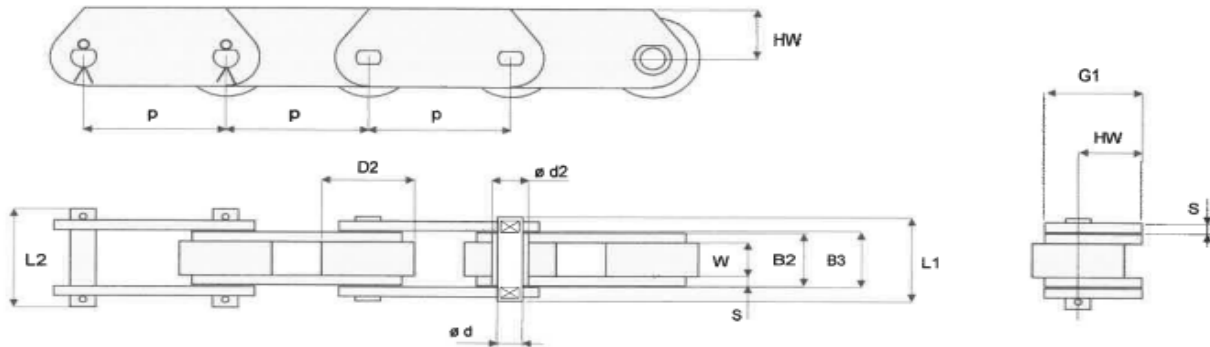

DIN 8167	p ( mm )												
MT - 20	40	50	63	80	100	125	160						
MT - 28		50	63	80	100	125	160	200					
MT - 40			63	80	100	125	160	200	250				
MT - 56			63	80	100	125	160	200	250				
MT - 80				80	100	125	160	200	250	315			
MT - 112				80	100	125	160	200	250	315			
MT - 160					100	125	160	200	250	315	400		
MT - 224						125	160	200	250	315	400	500	
MT - 315							160	200	250	315	400	500	630
MT - 450								200	250	315	400	500	630

- Tipo A : a bussole
- Tipo S : rulli standard
- Tipo P : rulli sporgenti
- Tipo F : rulli fiangati

Secondo Norma DIN 8167

dimensioni mm

 classe MT	CARATTERISTICHE CATENE									CARATTERISTICHE PIASTRE		
	largh interna	perno catena	diámetro rullo	largh maglia interna	largh interna m-esterna	lungth perno	max ingombro	(f) superf di snodo	carico rottura MIN	altezza piano lavoro	altezza totale piastra	spessore piastra
	W	d	D2	B2	B3	L1	L2	(cm2)	(KN)	HW	G1	S
MT - 20	16,0	6,0	25,0	22,0	22,2	35,0	49,0 <sup>2</sup>	1,32	20,0	16,0	25,0	2,5
MT - 28	18,0	7,0	30,0	25,0	25,2	40,0	56,0	1,75	28,0	20,0	30,0	3,0
MT - 40	20,0	8,5	36,0	28,0	38,3	45,0	63,0	2,38	40,0	22,5	35,0	3,5
MT - 56	24,0	10,0	42,0	33,0	33,3	52,0	72,0	3,30	56,0	30,0	45,0	4,0
MT - 80	28,0	12,0	50,0	39,0	39,4	62,0	86,0	4,68	80,0	32,5	50,0	5,0
MT - 112	32,0	15,0	60,0	45,0	45,5	73,0	101,0	6,75	112,0	40,0	60,0	6,0
MT - 160	37,0	18,0	70,0	52,0	52,5	85,0	117,0	9,36	160,0	45,0	70,0	7,0
MT - 224	43,0	21,0	85,0	60,0	60,6	98,0	134,0	12,60	224,0	60,0	90,0	8,0
MT - 315	48,0	25,0	100,0	70,0	70,7	112,0	154,0	17,50	315,0	65,0	100,0	10,0
MT - 450	56,0	30,0	120,0	82,0	82,8	135,0	185,0	14,60	450,0	80,0	120,0	12,0



OGNIBENE S.P.A. \_ VIA DEL TIPOGRAFO, 6 \_ 40138 BOLOGNA \_ ITALY  
 TEL: +39 051 534225 \_ FAX: +39 051 535083  
[sales@ognibenechaintech.it](mailto:sales@ognibenechaintech.it) \_ [www.ognibenechaintech.com](http://www.ognibenechaintech.com)