

CATENE OE CON ATTACCHI K36.1 (WA1) VERSIONE UNI-ISO E UNI-ISO 606

OE CHAINS WITH K36.1 (WA1) ATTACHMENTS UNI-ISO VERSION

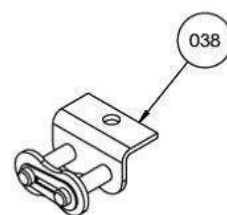
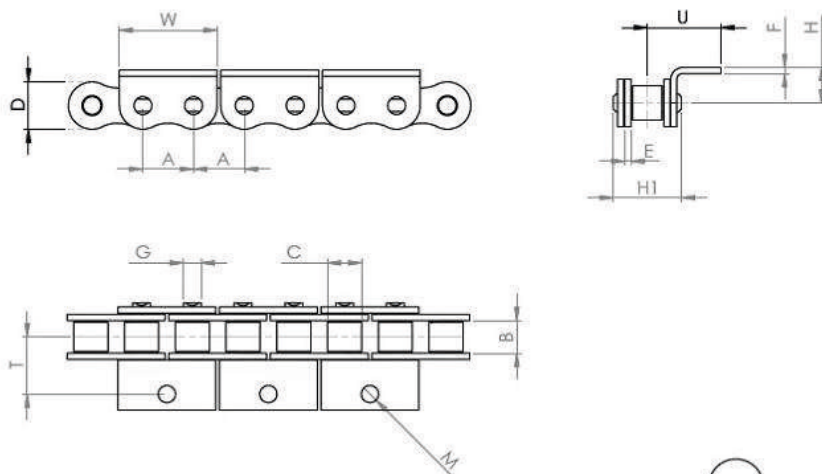
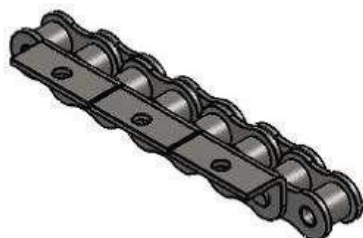

ISO STANDARD

| CHAIN CODE | REF. | A - PITCH (MM) | B - INSIDE WIDTH | C - ROLLER DIAM MIN | E - PLATE WIDTH INNER MAX | F - PLATE WIDTH OUTER MAX | G - PIN DIAM. MAX | H1 - PIN LENGTH MAX | W | H | M | T | U | ISO606 TENSILE STRENGTH (NEWTONS) MIN |
|--------------|------|----------------|------------------|---------------------|---------------------------|---------------------------|-------------------|---------------------|------|------|-----|-------|-------|---------------------------------------|
| 511603232UNI | 08B1 | 12.700 | 7.750 | 8.510 | 1.500 | 1.500 | 4.450 | 16.500 | 24.4 | 8.9 | 4.3 | 12.7 | 20.85 | 17800 |
| 511623232UNI | 10B1 | 15.875 | 9.650 | 10.160 | 1.500 | 1.500 | 5.080 | 18.800 | 29.9 | 10.3 | 5.3 | 15.9 | 24.8 | 22200 |
| 511642232UNI | 12B1 | 19.050 | 11.680 | 12.070 | 1.760 | 1.760 | 5.720 | 21.900 | 35.4 | 13.5 | 6.6 | 19.05 | 26.35 | 28900 |
| 511666232UNI | 16B1 | 25.400 | 17.020 | 15.880 | 3.700 | 3.000 | 8.280 | 34.900 | 46.2 | 15.9 | 6.6 | 25.4 | 42.8 | 60000 |