

GRUPPO MCC CATENE MAX TOP SEMPLICI ASA

MCC GROUP MAX TOP CHAIN SIMPLEX ASA

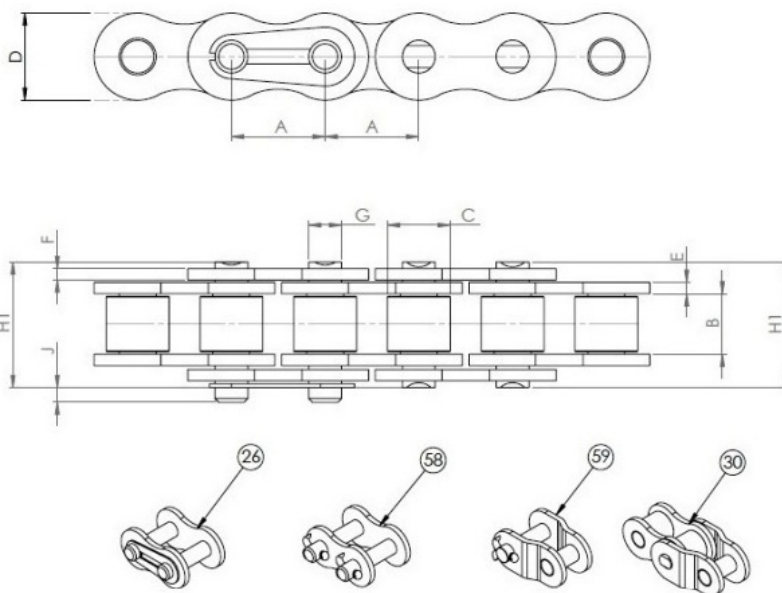

ANSI STANDARD													
CHAIN CODE	REF.	A - PITCH (MM)	B - INSIDE WIDTH	C - ROLLER DIAM MIN	D - PLATE HEIGHT MAX	E - PLATE WIDTH INNER MAX	F - PLATE WIDTH OUTER MAX	G - PIN DIAM. MAX	H1 - PIN LENGTH MAX	J - CONN. LINK EXTENSION MAX	ISO606 TENSILE STRENGTH (NEWTONS) MIN	ISO606 TENSILE STRENGTH (NEWTONS) MED	WEIGHT KG/M
600025000	25A1	6.350	3.100	3.300	5.900	0.760	0.760	2.300	7.900	1.200	3500	3500	0.120
600035000	35C1	9.525	4.680	5.080	8.600	1.290	1.290	3.590	12.000	1.700	7900	7900	0.350
600040000	40A1	12.700	7.850	7.920	11.200	1.550	1.550	3.970	16.400	2.100	13900	13900	0.600
600050000	50A1	15.875	9.400	10.160	14.600	2.040	2.040	5.080	20.400	2.700	21800	21800	1.000
600060000	60A1	19.050	12.570	11.910	17.500	2.450	2.450	5.940	25.300	2.600	31300	31300	1.470
600080000	80A1	25.400	15.750	15.880	24.130	3.250	3.250	7.940	32.700	3.000	55600	55600	2.800
600100000	100A1	31.750	18.900	19.050	30.170	4.060	4.060	9.540	39.700	4.200	87000	87000	4.200
600120000	120A1	38.100	25.230	22.230	36.200	4.800	4.800	11.110	49.300	5.300	125000	125000	5.700
600140000	140A1	44.450	25.230	25.400	42.230	5.610	5.610	12.710	52.900	5.200	170000	170000	7.800
600160000	160A1	50.800	31.550	28.580	48.260	6.350	6.350	14.290	63.100	6.500	223000	223000	10.400
600180000	180A1	57.150	35.480	35.710	54.300	7.110	7.110	17.460	70.600	7.900	281000	281000	13.940
600200000	200A1	63.500	37.850	39.670	60.330	8.130	8.130	19.850	76.900	9.000	347000	347000	17.300
600240000	240A1	76.200	47.350	47.620	72.390	9.800	9.800	23.800	94.400	10.500	500000	500000	25.000